

Loading Dock Gate

One and two-way spring-return gates designed to reduce operator falls by closing the gap between the rear end of trucks and the exposed dock edges on elevated loading docks.

PART No.	DESCRIPTION
LDG1000-90	Loading dock gate – 1000mm with 90 degree opening (10kgs)
LDG1000-180	Loading dock gate – 1000mm with 180 degree opening (10kgs)
CS90SM	Optional 90 x 90 x 1000mm high post

Description:	1-way and 2-way safety gates
Operation:	Spring-return
Construction:	Steel chassis with aluminium hoop
Gate Swing:	90 or 180 degrees
Gate Stop:	Self-centering
Receiver Post:	N/A
Maximum Opening:	1000mm wide
Minimum Opening:	600mm wide
Mounting Type:	Post or wall
Rail Type:	42.4mm diameter aluminium hoop
Rail Height:	1000mm above floor
Finish:	Powder coated

03

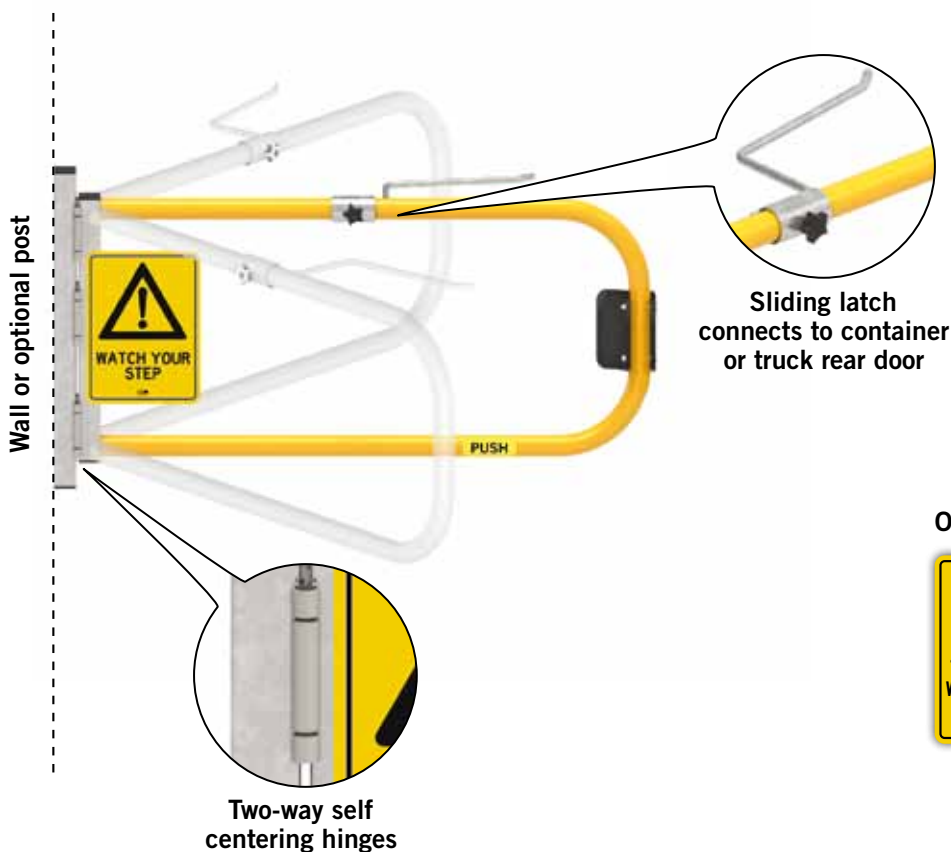

Optional safety signs



S1175-PP



S1174-PP



S1176-PP